

MARSHALL

Integration-Friendly Furniture®
Since 1986

ELCO Series

Quick Ship ELCO™-DUO20 Rack Cabinet



Overall Dimensions:
25" W x 42" H x 26" D

Standard Features Include:

- Surface Grommets
- Soft Close Locking Pocket Door
- ER-S Interior Configuration
- Locking Rear Access Panel
- Floor Access Opening
- 10"x10" Floor Vent
- Locking Carpet Casters

Popular Options:

- Small Interface Cutouts
- Cable Reservoirs
- AC Outlet with USB Ports
- Heavy Duty Drop Leaf Shelf
- ER-R or ER-TPR Interior Configurations
- Vented or Plexi Face Doors
- Pole Mount for Monitor (Up to 55" display, 100lb weight capacity)
- Video Conference Shelf for Pole Mounts
- Cooling Fan(s)



This ELCO-DUO20 is shown in Asian Night Melamine and includes optional External Cooling Fans.



Click Here or Call (847) 395-9350 to Request a Quote

Interior Configurations

ER-S Standard Configuration
Adjustable Shelf

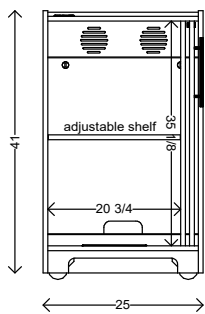

ER-R
Fixed Rack Rail

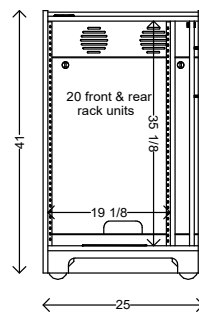

ER-TPR
Space for Third Party Rack

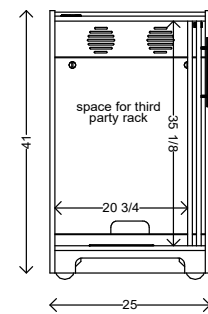

Specifications subject to change without notice - Some options may affect lead time

Stock Melamine Colors - *Black, Silver Frost, & Maple Ship in 10 Business Days - All Other Colors Ship in 30 Days - Printed Colors are Approximate - Samples Available Upon Request

Standard



Designer Series

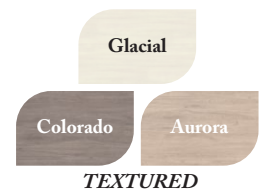

Ask about our FSC®
Certified Products
SCS-COC-004377 K

Marshall Furniture Inc ❖ www.marshallfurniture.com
999 Anita Avenue ❖ Antioch IL 60002 ❖ P 847-395-9350 ❖ F 847-395-9351

© Copyright 2020 All Rights Reserved, Marshall Furniture Inc.

November 2020



MADE IN USA